









alhashit











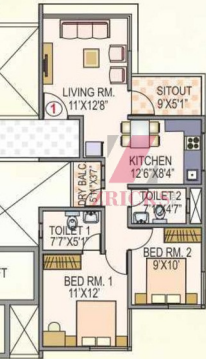



TRICKS

6

801, 90



**Independent Bungalow**  
**TYPE - H1**



**GROUND FLOOR PLAN**



**FIRST FLOOR PLAN**

Unit no. - 97.1, 97.4, 97.5

TYPE	CARPET AREA	TERRACE	PARKING
H1	2178	434	368

**Independent Bungalow**  
TYPE - K1



**GROUND FLOOR PLAN**



**FIRST FLOOR PLAN**

Unit no. - 97.6

TYPE	TOTAL CARPET	TERRACE	PARKING
K1	2225	173	369

**Independent Bungalow**  
TYPE - 11



**GROUND FLOOR PLAN**



**FIRST FLOOR PLAN**

Unit no. - 97.2

TYPE	CARPET AREA	TERRACE	PARKING
11	2742	166	369

**Independent Bungalow**  
TYPE - F1



**GROUND FLOOR PLAN**



**FIRST FLOOR PLAN**

Unit no. - 97.3, 114.2, 114.3

TYPE	CARPET AREA	TERRACE	PARKING
F1	3266	140	369







**THE ARENA**

Outdoor and adventure activities the like of which you expect to enjoy only in very high end. Suitable destinations

- Mountain Biking
- Rock Climbing
- Aerialy Surfer
- Paint Ball
- ATV Track

**THE RIDGE**

Linked with the Ridge

**MEADOWS**

Independent Residences overlooking the eastern valley

- Water View
- Children's Play Area
- Landscaped Garden

**THE CLIFF**

With up to large Children's play area that includes

- Spa
- Swimming Pool
- Play-riding Playground
- Tennis Court
- Soccer Field
- Basketball
- A Valley View Guest House
- Pool Tables
- Squash Court
- Fully Equipped Gym
- Barbecue Hall
- Storage Deck

**CRESCENT**

Subsidiary Residences

- Stunning location on the top of a cliff
- Beautiful landscaping walking trails

**CASCADE**

New Homes, Independent Residences. These Residences that have been built on a gentle slope, with a stunning effect

- Gorgeous views of Mount Lavinia
- Spa Deck
- Beautiful landscaping walking trails
- Children's Play Area
- Party Lawn with Gazebo

**THE CREST**

Independent Residences surrounded by dense forest

**THE HIGHLANDS**

2 & 3 Bed Premium Apartments

- Landscaped Garden
- Entertainment Terrace
- Glass Screen
- Entrance Floor
- Parking Space
- Jogging Tracks

**STALLION**

An exquisite walking estate beyond compare

- Riding Club
- Coffee Shop
- Stable

**THE MALL**

A full featured Shopping Mall

- Multiple features with convenient street access

**CORE GATE**

A beautifully designed feature of the township

- Security Gate
- Security Checkpoint

**Dr Sri Ravichandrar Vajra Mantra**

State of the Art School for the future generation

- CBSE Curriculum
- Child friendly, value based education
- Excellent academics and infrastructure
- Playground

**BRIDGE**

Beautifully designed Entrance style Bridge

**ATREASHRI**

Residential apartments surrounded by water features - a highly renowned Perpetual Springs Initiative

- 24 Hours Security
- Shuttle Bus Service
- Tennis court
- Amphitheatre
- Recreational Center
- Clubhouse, Gym, Cardio Room
- Library
- Gardens
- Maintenance Services

**TIERRA**

Proposed Theme Garden

- Pet Zone
- Security Garden
- Columns

**PEDESTALS**

Proposed high rise Apartments

**MAIN GATE**

**PEBBLES**

1 & 2 Bed Smart Homes that are smart homes for the smart buyer!

- High Speed Shopping
- Spa Hall

**PROPOSED THE COVE**

A Nature Based Site a Refinement of the Cove. Ideal with an unlimited height potential

- Glass Lobby
- Pool
- Mass Recreation
- Spa House
- Pool Deck
- Children's Play Area
- Columns

**FOREST TRAILS WELCOME CENTER**

This is where your journey of exploring Forest Trails begins!

**SIENE**

Proposed Residences

**EVERGLADES**

Proposed high rise Apartments



LAYOUT



Building A

Building B

Main Entrance



Artist Impression

Layout



ZRICKS

